

BLOOM TOWNSHIP SECTION 27 R12 TWP 11 MORGAN COUNTY, OH

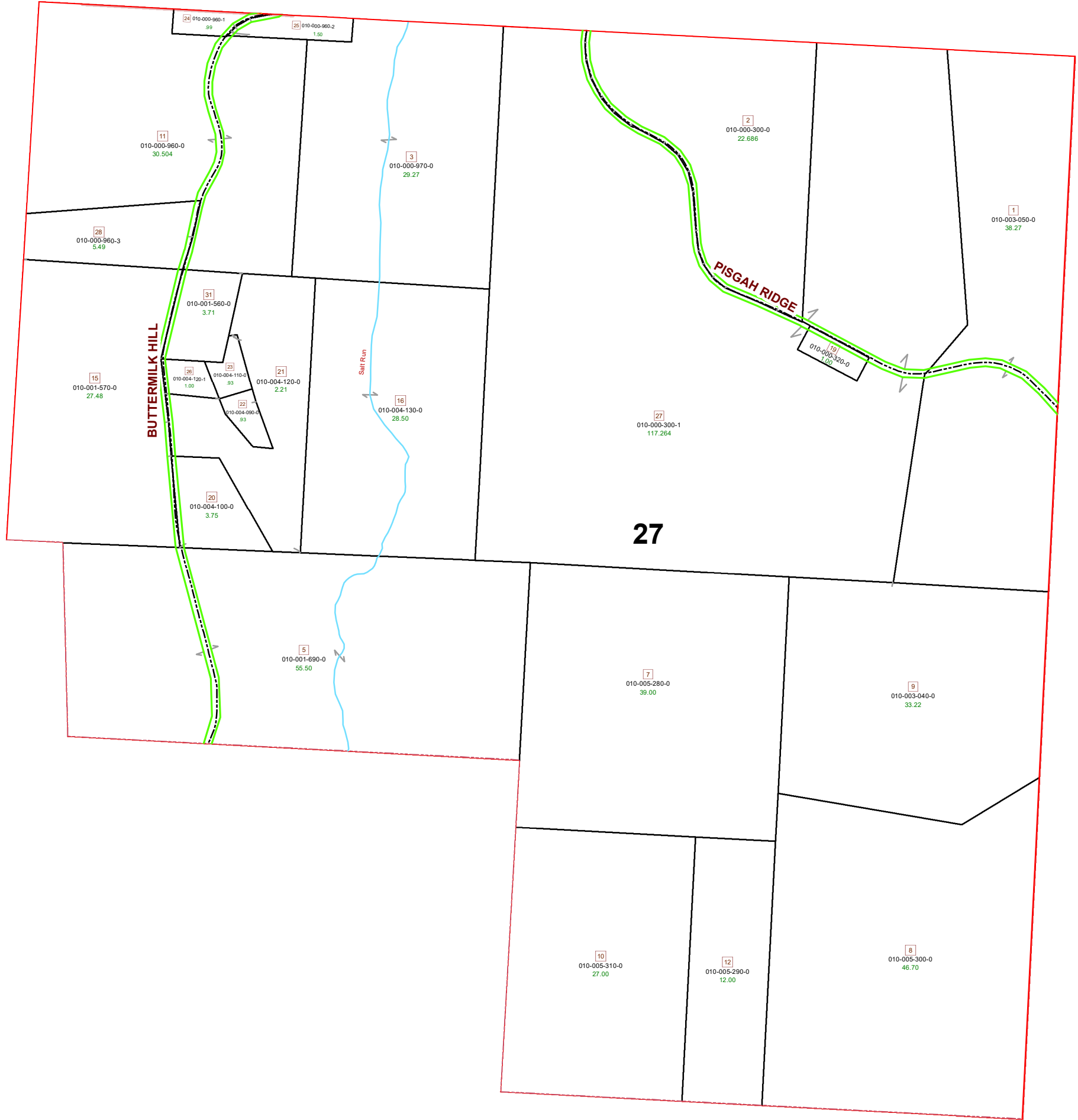

PIN	VOL	PAG	Owner	LegalDescr	Acres
010-000-300-0	OR232	2154	APPERSON J LEE	R12 T11 S27 SD 2	22.686
010-005-290-0	D.V. 185	374	APPERSON JERRY L & RICHARD J	R12 T11 S27 SD 12	12
010-005-310-0	D.V. 18	374	APPERSON JERRY L & RICHARD J	R12 T11 S27 SD 10	27
010-005-300-0	D.V. 185	374	APPERSON JERRY L & RICHARD J	R12 T11 S27 SD 8	46.7
010-005-280-0	D.V. 185	374	APPERSON JERRY L & RICHARD J	R12 T11 S27 SD 7	39
010-003-040-0	OR98	52	APPERSON JLEE	R12 T11 S27 SD 9	33.222
010-000-300-1	OR0228	2753	APPERSON JLEE	R12 T11 S27 SD 27	117.26
010-003-050-0	OR98	52	APPERSON JLEE	R12 T11 S27 SD 1	38.274
010-001-560-0	OR222	2688	EADES MICHAEL J & JENNIFER	R12 T11 S27 SD 31 SURVI	3.711
010-001-570-0	OR222	2686	EADES MICHAEL J & JENNIFER	R12 T11 S27 SD 15 PART	27.48
010-001-690-0	OR204	1984	EMBREE ROBERT & TIMOTHY & LARRY	R12 T11 S27 SD 5	55.5
010-000-960-2	OR211	645	JENNER MARCIA A & ROBIN KRAUSE LC-DAVID	R12 T11 S27 SD 25 SURVI	1.5
010-000-960-1	OR117	235	MCKINLEY CHARLES R & CONNIE J BALTHASER	R12 T11 S27 SD 24 SURVI	0.998
010-000-320-0	OR230	3202	MCKITRICK KAREN	R12 T11 S27 SD 19	1
010-004-130-0	OR214	1219	MURPHEY MICHAEL S & RICHARD B	R12 T11 S27 SD 16	28.5
010-004-120-0	OR214	1219	MURPHEY MICHAEL S & RICHARD B	R12 T11 S27 SD 21	1.219
010-004-100-0	OR212	3162	MURPHEY RICHARD B	R12 T11 S27 SD 20	3.75
010-004-090-0	D.V. 18	65	MURPHEY RICHARD B	R12 T11 S27 SD 22	0.93
010-004-110-0	D.V. 17	565	MURPHEY RICHARD B	R12 T11 S27 SD 23 EX AL	0.93
010-004-120-1	OR212	3162	MURPHEY RICHARD B	R12 T11 S27 SD 26	1
010-000-960-3	OR232	5456	TUCKER PATRICK JOSEPH	BEING SD 28 FROM SD 11	5.498
010-000-970-0	OR229	736	TUCKER PATSY	R12 T11 S27 SD 3	29.273
010-000-960-0	OR229	736	TUCKER PATSY	R12 T11 S27 SD 11	30.51

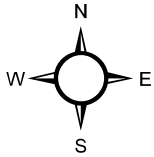

Boundaries	
	Lot
	ROW
	Roads
	County
	Section
	Hidden
	Township
	Sections
	Parcels

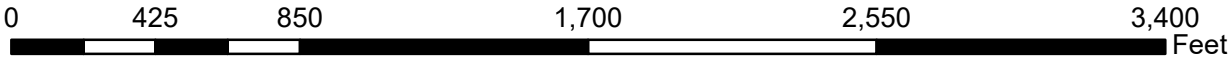

Disclaimer: The Information that these maps contains is for reference purposes only. Please bring any errors to the attention of the Engineer's Office staff. Thank You

Morgan County Engineer's Office
 Author: Marcia Wolfe
 Date: 7/20/2020